



9 Norfolk Street The Entrance NSW

3  1  1 

Neat and tidy 2 bedroom freestanding home with additional sleepout studio located in the heart of The Entrance. This property features a neat and tidy kitchen, open plan lounge and dining area, neat and tidy bathroom, 2 good sized bedrooms with ceiling fans, separate study space, undercover deck great for entertaining, fully fenced yard, external laundry and a single garage.

The property is centrally located being only a short distance to the heart of The Entrance and main street of Long Jetty.

The property would suit a couple or single person with space to work from home.

Pets would be considered on application
6 month lease to start

Type : House

View : <https://www.whitemanproperty.com.au/lease/nsw/central-coast-region/the-entrance/residential/house/7369669>



Scott Falzon
02 4384 1349



Laetitia Jones
02 43841349

[For full version visit the website](https://www.whitemanproperty.com.au)



FIRST FLOOR

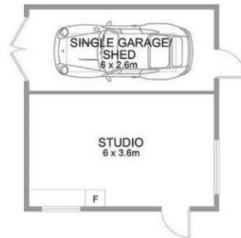

9 Norfolk St, The Entrance