



11 Bronzewing Drive Erina NSW

4 2 2

Well-appointed 4-bedroom split-level home in a popular pocket of Erina

This beautiful property boasts an open-plan design with high ceilings and skylights, allowing abundant natural light to flow throughout the home. It offers the following features:

- 4 large bedrooms
- Ensuite bathroom
- Spacious lounge and entertaining area
- Separate dining area off the kitchen
- Internal laundry
- Covered decking area
- Double garage
- Solar Panels

Located in close proximity to Erina Fair and local transport

View : <https://www.whitemanproperty.com.au/lease/nsw/central-coast-region/erina/residential/house/7742875>



Georgie Crum
0450 973 916

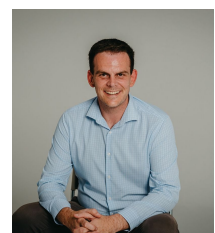

Scott Falzon
02 4384 1349

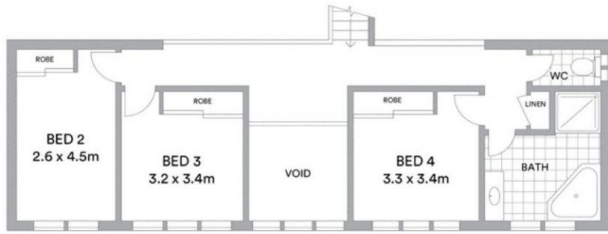

FIRST FLOOR

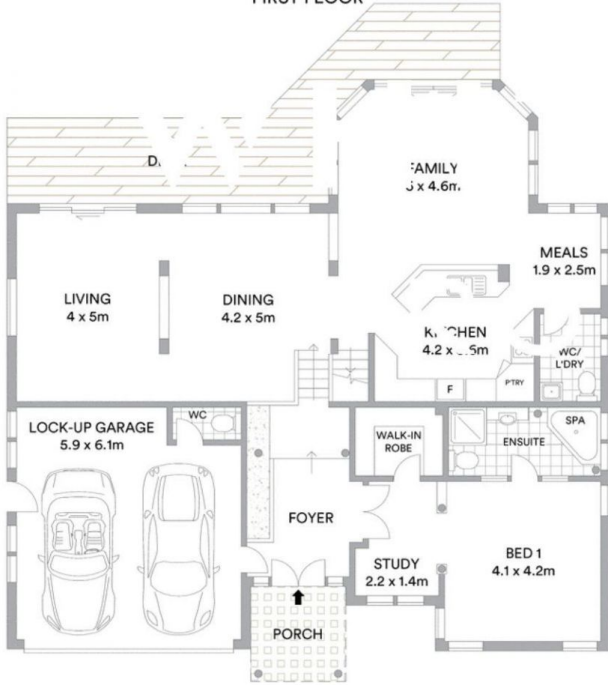

GROUND FLOOR



Internal 249sqm
External 414sqm
Land area 610sqm

WHITEMAN
PROPERTY

Scale in metres. Indicative only. All information contained herein is obtained from sources we believe to be accurate. We cannot guarantee its accuracy. Interested persons should make and rely on their own enquiries