

# WHITEMAN PROPERTY

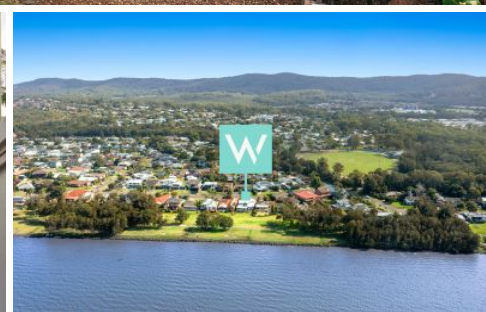

11 Hinemoa Avenue Killarney Vale NSW

4  2  2 

A tranquil setting boasting uninterrupted views over Tuggerah Lake from the bright and breezy interiors of this stylish family haven. The four-bedroom home features a choice of living spaces embracing the water view and outdoors to a choice of spaces to relax, play and entertain. Exuding a fresh and inviting aesthetic that reflects its relaxed coastal setting, this designer family home leaves no expense spared for modern day luxury.

Enjoy stunning sunsets and sunrises from living, dining and bedrooms through the perfect use of over-sized windows and glass sliding doors. Sea breezes flow effortlessly through louvre windows on both levels.

The master suite is a haven boasting water views and an undercover balcony to relax and watch the sunrise over the lake.

**Price** : \$ 1,570,000  
**Building Size** : 225 sqm  
**Land Size** : 556 sqm  
**View** : <https://www.whitemanproperty.com.au/sale/nsw/central-coast-region/killarney-vale/residential/house/7940620>



**Ricky Cavarra**  
02 4384 1349



**Brian Whiteman**  
02 4384 1349

<https://www.whitemanproperty.com.au>

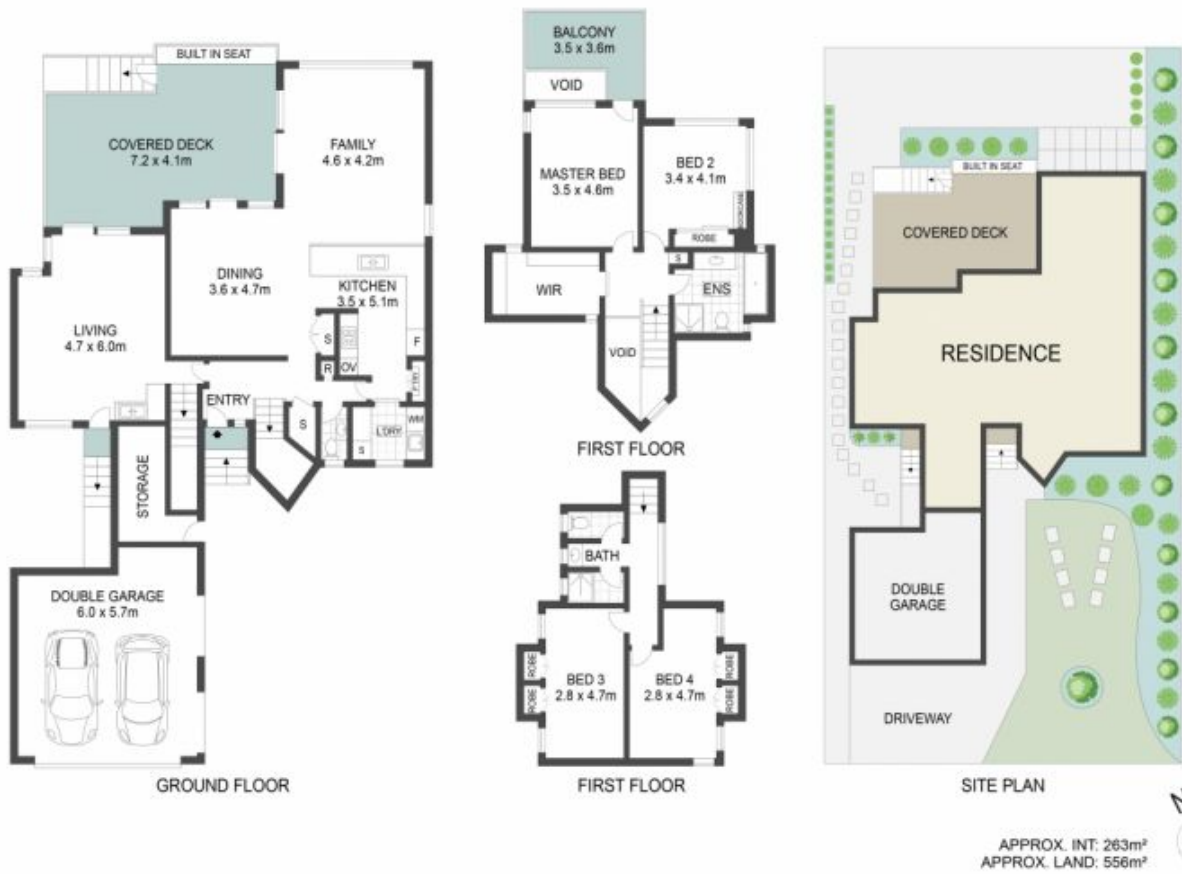

THE INFORMATION CONTAINED IN THIS DOCUMENT HAS BEEN PROVIDED BY THIRD PARTIES. WHITEMAN PROPERTY HAS NOT CHECKED THE INFORMATION AND MERELY PASSES IT ON WITHOUT HAVING A BELIEF ONE WAY OR THE OTHER AS TO ITS ACCURACY. INTERESTED PARTIES SHOULD MAKE AND RELY UPON THEIR OWN ENQUIRIES.



11 Hinemoa Avenue, Killarney Vale

WHITEMAN  
PROPERTY