

WHITEMAN PROPERTY



148 Thomas Mitchell Road Killarney Vale NSW

4 2 2

Perfectly set on an impressive 719sqm parcel of land, this generously proportioned single level residence is a first-class family dwelling perfect for everyday living and entertaining. Boasting a modern layout the home offers a connected sense of living with the living and dining areas situated off the centrally located kitchen, in addition to an effortless flow out to the backyard entertaining area and in-ground swimming pool.

High ceilings, neutral tones and over-sized windows compliment this amazing home. The undercover entertaining flows effortlessly through glass doors and over-looks the fully fenced yard and swimming pool. The main bedroom is perfectly positioned and boasts an ensuite and walk in robe. Three good sized bedrooms all come complete with built in robes.

Price : Contact Agent
Land Size : 719 sqm
View : <https://www.whitemanproperty.com.au/sale/nsw/central-coast-region/killarney-vale/residential/house/7957405>



Simon Mitrovich
02 4384 1349



Brian Whiteman
02 4384 1349

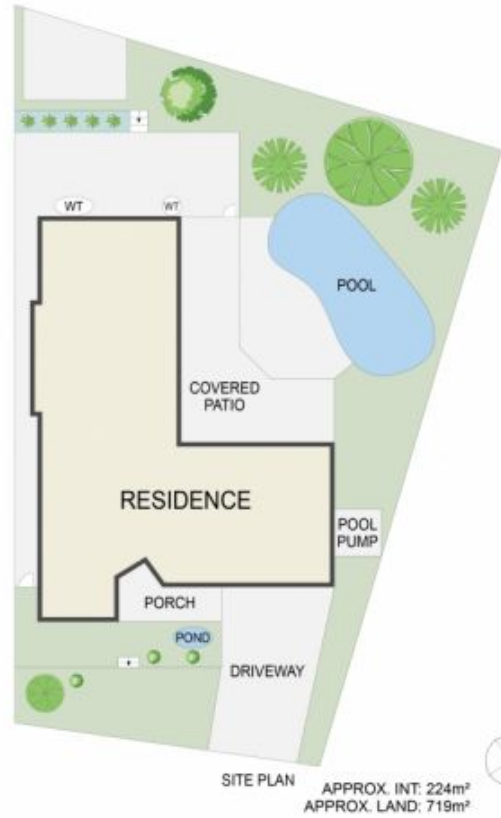

THE INFORMATION CONTAINED IN THIS DOCUMENT HAS BEEN PROVIDED BY THIRD PARTIES. WHITEMAN PROPERTY HAS NOT CHECKED THE INFORMATION AND MERELY PASSES IT ON WITHOUT HAVING A BELIEF ONE WAY OR THE OTHER AS TO ITS ACCURACY. INTERESTED PARTIES SHOULD MAKE AND RELY UPON THEIR OWN ENQUIRIES.



148 Thomas Mitchell Road, Killarney Vale

WHITEMAN
PROPERTY