

# WHITEMAN PROPERTY



## 14 Malana Avenue Bateau Bay NSW

3  2  2 

Set on a North facing sunny 550sqm block of land in a coveted East Bateau Bay location, just a short distance to the beach. This fantastic cottage comes with full DA approved stunning plans for a future palatial two storey family home with over-sized windows throughout to capture natural light and sea breezes. The DA approved plans come complete with fantastic undercover outdoor entertaining over-looking a resort style pool and fully fenced yard perfect for children to play.

The existing home has been beautifully updated blending character features with contemporary updates to create a comfortable beachside home.

- Light and bright living areas with high ceilings and flow to deck
- Master bedroom on the ground floor with ensuite

**Price** : Contact Agent  
**Land Size** : 550 sqm  
**View** : <https://www.whitemanproperty.com.au/sale/nsw/central-coast-region/bateau-bay/residential/house/7994537>



**Josh Froud**  
02 4384 1349

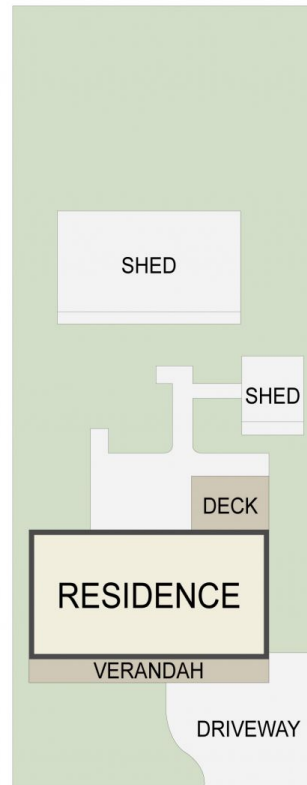
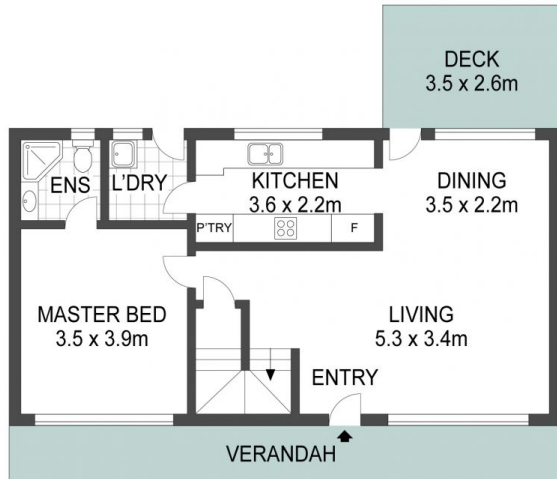
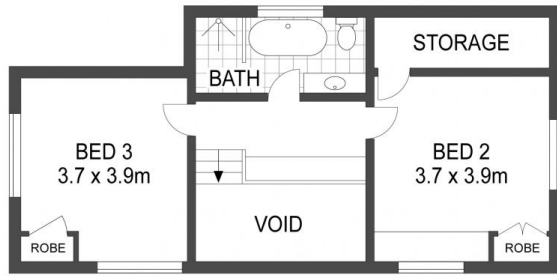

APPROX. INT: 116m<sup>2</sup>  
 APPROX. LAND: 550m<sup>2</sup>



THE INFORMATION CONTAINED IN THIS DOCUMENT HAS BEEN PROVIDED BY THIRD PARTIES. WHITEMAN PROPERTY HAS NOT CHECKED THE INFORMATION AND MERELY PASSES IT ON, NOT HAVING A BELIEF ONE WAY OR THE OTHER AS TO ITS ACCURACY. INTERESTED PARTIES SHOULD MAKE AND RELY UPON THEIR OWN ENQUIRIES.



14 Malana Avenue, Bateau Bay

WHITEMAN  
PROPERTY