

# WHITEMAN PROPERTY

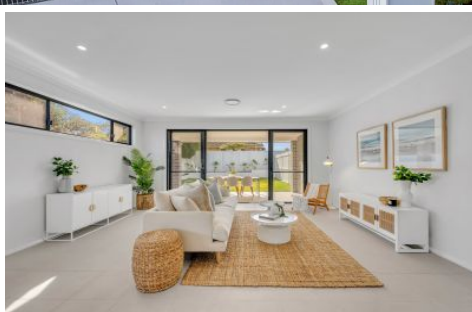

## 40a Elsiemer Street Long Jetty NSW

4 2 1

Delivering house-like proportions, premium finishes, and cutting-edge design, this brand-new duplex sets a new benchmark in luxury living. Set over two levels and capturing a sun-soaked north-to-rear aspect, the home blends indoor-outdoor flow with a low-maintenance lifestyle just moments to beaches, local cafés, and vibrant coastal trails. Ideal for downsizers, holidaymakers or investors seeking quality and location.

- North-to-rear aspect, designed for light and space
- Two separate living zones across both levels
- Covered alfresco and fully fenced rear yard
- Gourmet kitchen with island, gas cooktop, quality appliances
- Main bedroom with ensuite and walk-in robe, lovely

[For full version visit the website](https://www.whitemanproperty.com.au)

**Type** : House  
**Price** : \$ 1,420,000  
**Land Size** : 338.5 sqm  
**View** : <https://www.whitemanproperty.com.au/sale/nsw/central-coast-region/long-jetty/residential/house/8377704>



**Dan McLaren**  
02 4384 1349



**Brian Whiteman**  
02 4384 1349

<https://www.whitemanproperty.com.au>

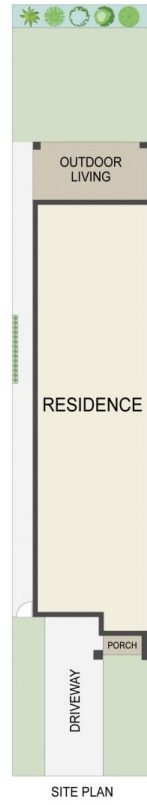
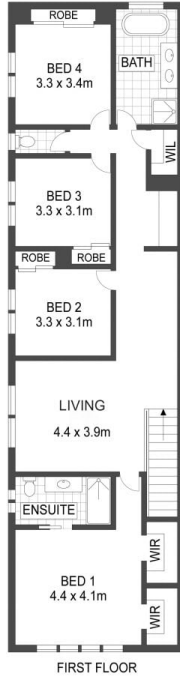

THE INFORMATION CONTAINED IN THIS DOCUMENT HAS BEEN PROVIDED BY THIRD PARTIES. WHITEMAN PROPERTY HAS NOT CHECKED THE INFORMATION AND MERELY PASSES IT ON, NOT HAVING A BELIEF ONE WAY OR THE OTHER AS TO ITS ACCURACY. INTERESTED PARTIES SHOULD MAKE AND RELY UPON THEIR OWN ENQUIRIES.



40A Elsiemer Street, Long Jetty

WHITEMAN  
PROPERTY